



SABAH INTERNATIONAL
CONVENTION CENTRE

Experience EXCEPTIONAL
SABAH NATURE & CULTURE



ASEAN MICE
VENUE STANDARD

Category Meeting Room 2024 - 2026
Category Exhibition Venue 2024 - 2028



MINISTRY OF TOURISM, ARTS & CULTURE
MALAYSIA

ASEAN MICE VENUE STANDARD
NATIONAL LEVEL

Category Meeting Room 2024 - 2026
Category Exhibition Venue 2024 - 2026



THE BRANDLAUREATE
Sustainable Business & Brands
Inspirational Achievement
Awards 2022-2023



The BrandLaureate
BestBrand Award for
Nation's Pride in
International Convention Centre
2023-2024



Room	Length	Width	Gross area		Banquet	Cluster	Classroom	Theatre	U-shape	Board Room	Booth Capacity	Cocktail
	m	m	sqm	sqf								

LEVEL 2 EXHIBITION HALLS, MEETING ROOMS & VVIP LOUNGE

Kinabatangan Foyer	17.140	105.300	1,804.84	19,427.14							68	1,500
Kinabatangan I	49.650	33.365	1,721.97	18,535.13	950	760	600	1,000	700	700	84	1,500
Kinabatangan II	49.650	33.890	1,749.40	18,830.38	950	760	600	1,000	700	700	98	1,500
Kinabatangan III	49.650	33.600	1,746.53	18,799.49	950	760	600	1,000	700	700	98	1,500
Kinabatangan I - III	49.650	100.855	5,007.45	53,899.74	2,800	2,240	1,800	3,000	220	232	280	4,800
201 Manukan	12.514	9.331	116.77	1,256.90	60	48	50	100	27	30		
202 Kapalai	12.282	9.322	114.49	1,232.36	60	48	50	100	27	30		
203 Mabul	11.815	9.145	108.05	1,163.04					35			
204 Mataking	11.965	9.328	111.60	1,201.25	60	48	50	100	27	30		
205 Balambangan	9.325	8.375	78.10	840.66	40	32	36	60	21	24		
206 Pandan-Pandan	4.804	9.308	44.72	481.40	20	16	18	30		12		
Silam Lounge (VVIP Lounge)	16.368	9.237	151.19	1,627.40	80			30	15	18		
Silam Foyer	42.400	13.900	589.36	6,343.82	150							80
Promenade	105				400							800

LEVEL 3 MAIN LOBBY, OPEN PLAZA, PERFORMING ARTS HALL (P.A.H.), VVIP ROOM & VIP LOUNGES

Jesselton Square (Open Plaza)			6,954.00	74,852.23	1,500						180	
R1 Danum (VVIP Room)	14.650	5.950	87.168	938.27	50	40	30	50	20	23		
R2 Imbak I (VVIP Room)	9.700	6.550	63.535	683.89	20	16	18	20	15	18		
L1 Imbak Lounge (VIP Lounge)	14.175	6.060	85.901	924.63	50	40		30				
R3 Imbak II (VVIP Room)	11.580	5.520	63.922	688.05	40	32	18	40	24	27		
R4 Mailau (VVIP Room)	9.400	6.490	61.006	656.66	20	16	12	20	15	18		

LEVEL 4 CONVENTION HALLS

Sipadan Foyer	17.000	113.400	1,927.80	20,750.67	400			300			68	1,500
Sipadan I	51.400	32.350	1,662.79	17,898.12	800	640	648	1,200	80	86	92	1,500
Sipadan II	51.400	33.150	1,703.91	18,340.73	800	640	648	1,200	80	86	92	1,500
Sipadan III	51.400	32.750	1,683.35	18,119.43	800	640	648	1,200	80	86	92	1,500
Sipadan I - III	51.400	98.250	5,050.05	54,358.29	3,200	2,560	2,400	8,000	220	232	276	4,800
PAH Foyer	48.650	8.160	396.98	4,273.06	200	160	80	150				120

LEVEL 5 MEETING ROOMS & EXECUTIVE MEETING SUITE

501 Kadamaian	8.357	7.480	62.51	672.85	30	21	24	50	15	18		
502 Mesilau	9.236	7.481	69.09	743.68	40	21	24	50	21	24		
503 Dinawan	12.540	7.491	93.94	1,011.16	60	42	36	60	27	30		
504 Madai	8.525	6.692	57.05	614.08	30	21	24	42	15	18		
505 Sepitok	25.160	7.500	188.70	2,031.15	100	60	54	120	40	43		
506 Selingan	8.347	6.579	54.91	591.05	20	16	24	30	15	18		
507 Monsopiad	7.195	4.695	33.78	363.60	20	16	24	30		10		
508 Kilas	7.316	4.660	34.09	366.94	20	16	24	30		10		
509 Kinabalu I	8.518	8.750	74.53	802.23	40	28	24	40	15	24		30
510 Kinabalu II	8.518	8.540	72.74	782.97	40	28	24	40	15	15		30
511 Kinabalu III	8.518	8.750	74.53	802.23	20	16	18	20				20
Kinabalu I-III	8.518	26.04	221.80	2,387.44	120	72	100	180	60	63		120
Kinabalu Foyer I	36.900	8.070	297.78	3,205.28	180	112	80	180	50	53	10	150
Kinabalu Foyer II	62.500	7.454	465.87	5,014.64	200	160	120	300			18	120
Lotus	17.750	7.760	137.74	1,482.62	40							32
Layang-Layang Lane	50.700	8.255	418.53	4,505.02	200	160	80	150				120

LEVEL 2 - EXHIBITION FLOOR / PROMENADE

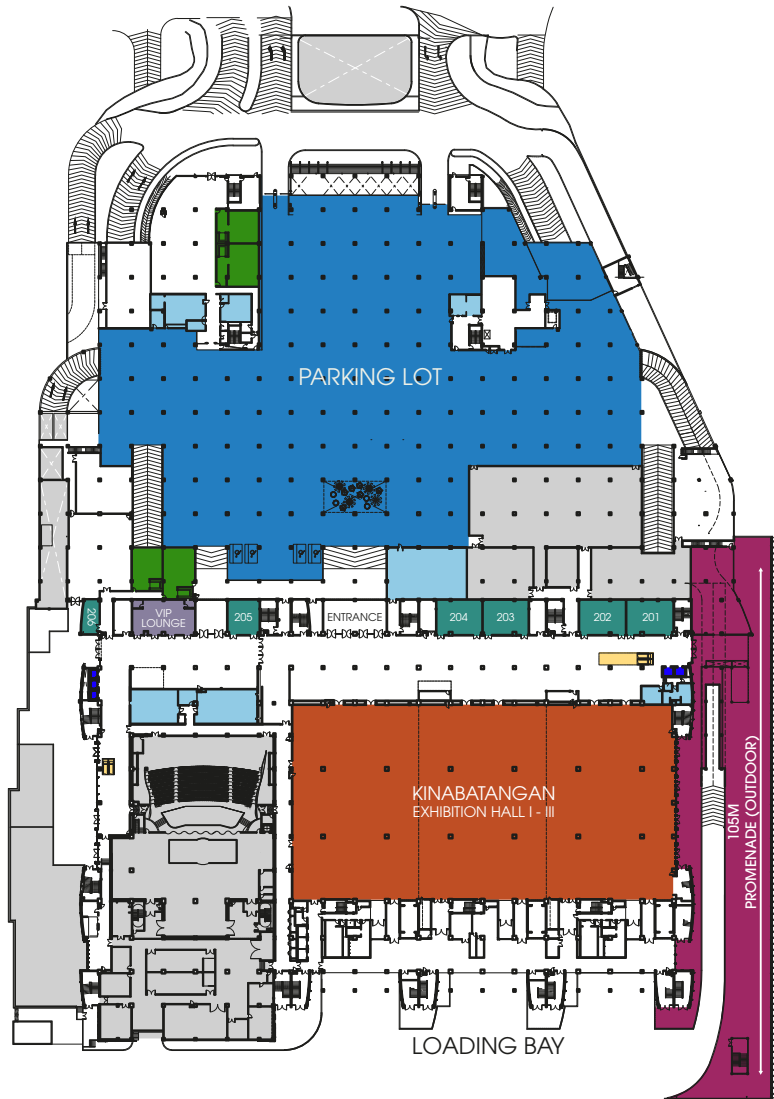

Notes

LEVEL 2 - MULTIPURPOSE EVENT SPACE

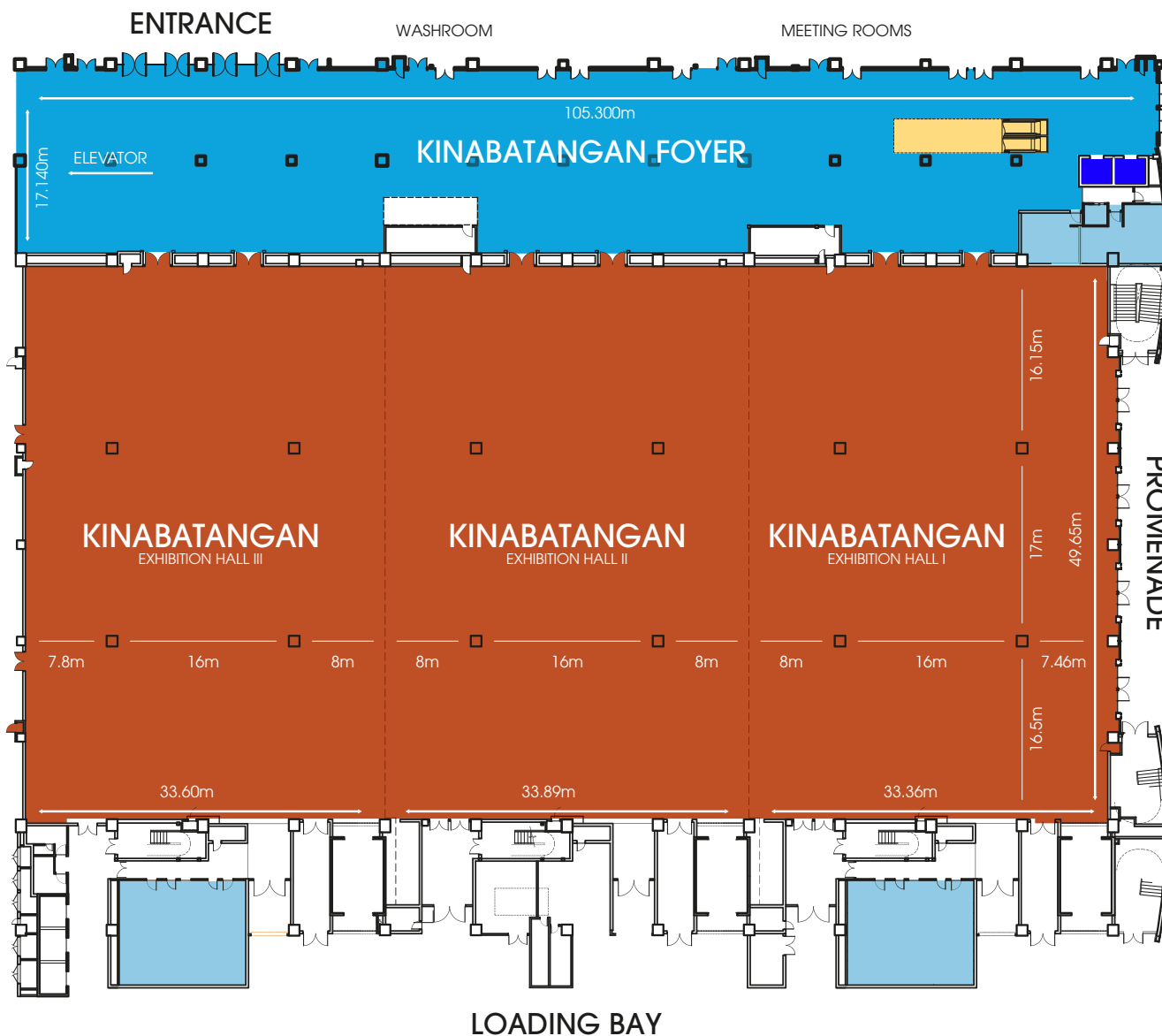

Room				
	m	m	sqm	sqf
Kinabatangan Foyer	17.140	105.300	1,804.84	19,427
Kinabatangan I	49.650	33.365	1,721.97	18,535.13
Kinabatangan II	49.650	33.890	1,749.40	18,830.38
Kinabatangan III	49.650	33.600	1,746.53	18,799.49
Kinabatangan I - III	49.650	100.855	5,007.45	53,899.74

Notes

LEVEL 2 - MEETING ROOMS



Room	Length	Width	Gross area	
	m	m	sqm	sqft

201 Manukan	12.514	9.331	116.77	1,256.90
202 Kapalai	12.282	9.322	114.49	1,232.36
203 Mabul	11.815	9.145	108.05	1,163.04
204 Mataking	11.965	9.328	111.60	1,201.25
205 Balambangan	9.325	8.375	78.10	840.66
206 Pandan-Pandan	4.804	9.308	44.72	481.40
Silam Lounge (VVIP Lounge)	16.368	9.237	151.19	1,627.40
Silam Foyer	42.400	13.900	589.36	6,343.82

Notes



- WASHROOM
- ESCALATOR
- ELEVATOR
- MEETING ROOM
- VIP LOUNGE
- SILAM FOYER

LEVEL 3 - MAIN LOBBY

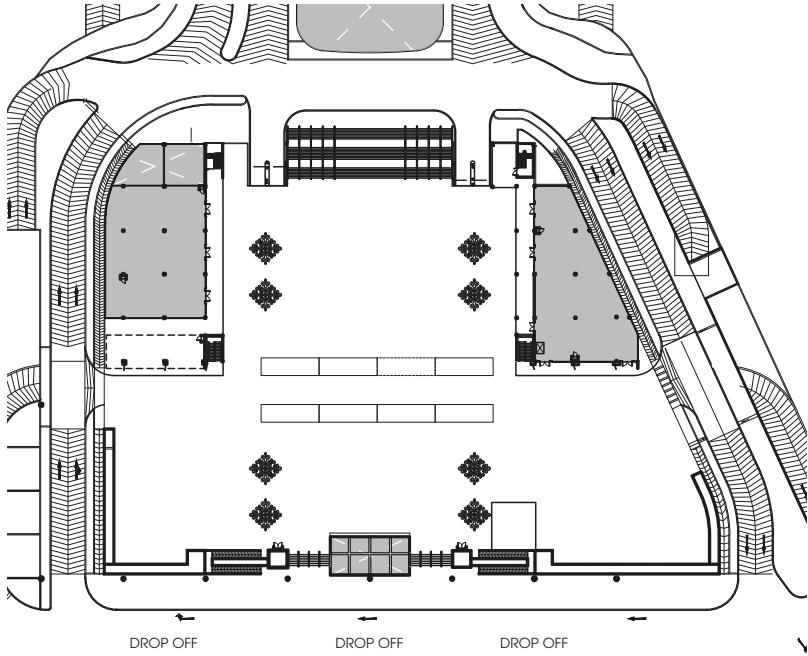

Notes



LEVEL 3 - PROFESSIONAL MEETING SPACE

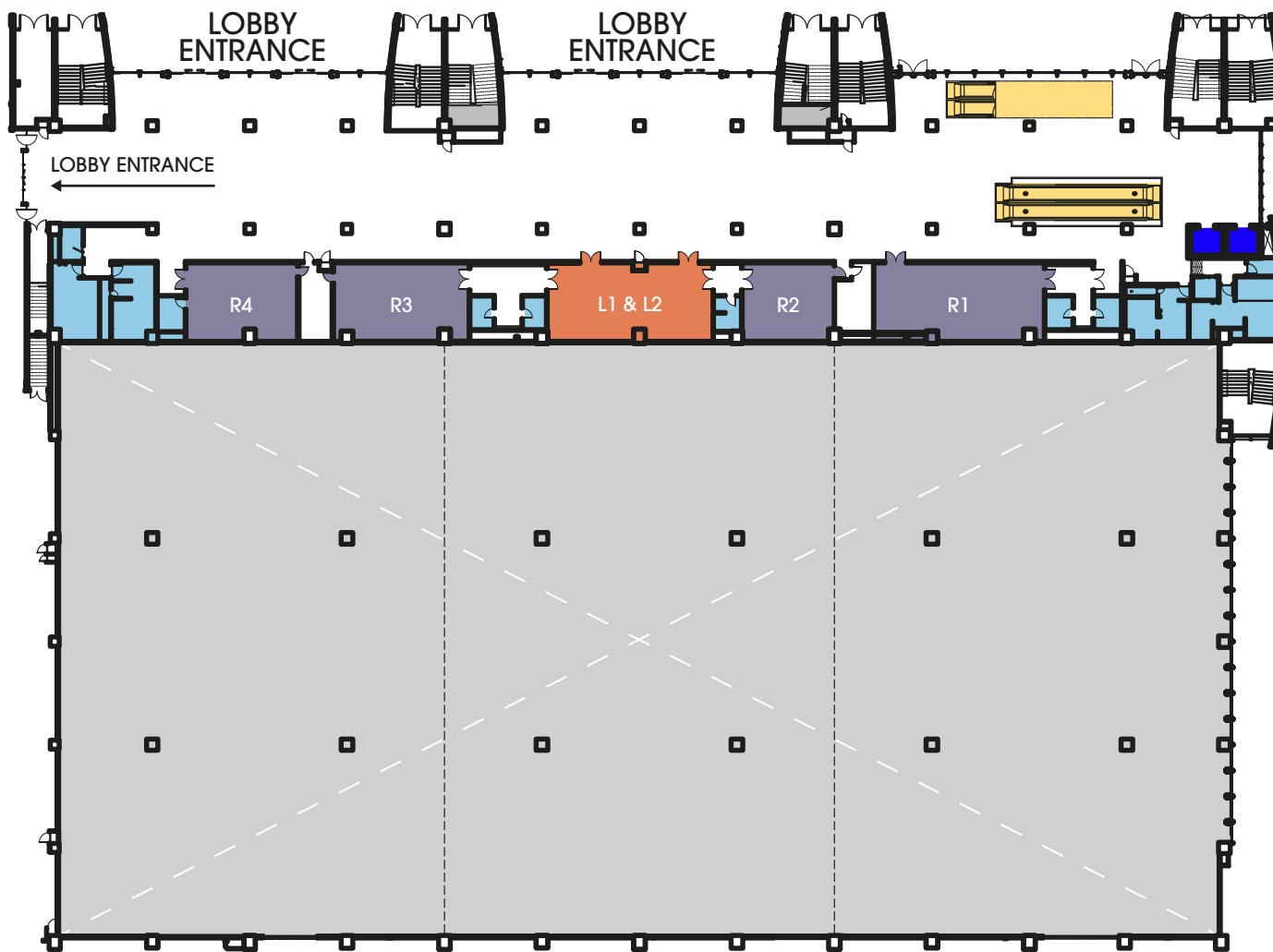

Room		Length	Width	Gross area	
		m	m	sqm	sqf
R1	Danum (VVIP Room)	14.650	5.950	87.168	938.27
R2	Imbak I (VVIP Room)	9.700	6.550	63.535	683.89
L1	Imbak Lounge (VIP Lounge)	14.175	6.060	85.901	924.63
R3	Imbak II (VVIP Room)	11.580	5.520	63.922	688.05
R4	Maliau (VVIP Room)	9.400	6.490	61.006	656.66

Notes

■ WASHROOM
 ■ ESCALATOR
 ■ ELEVATOR
 ■ VIP LOUNGE
 ■ VIP ROOM

LEVEL 4 - CONVENTION FLOOR

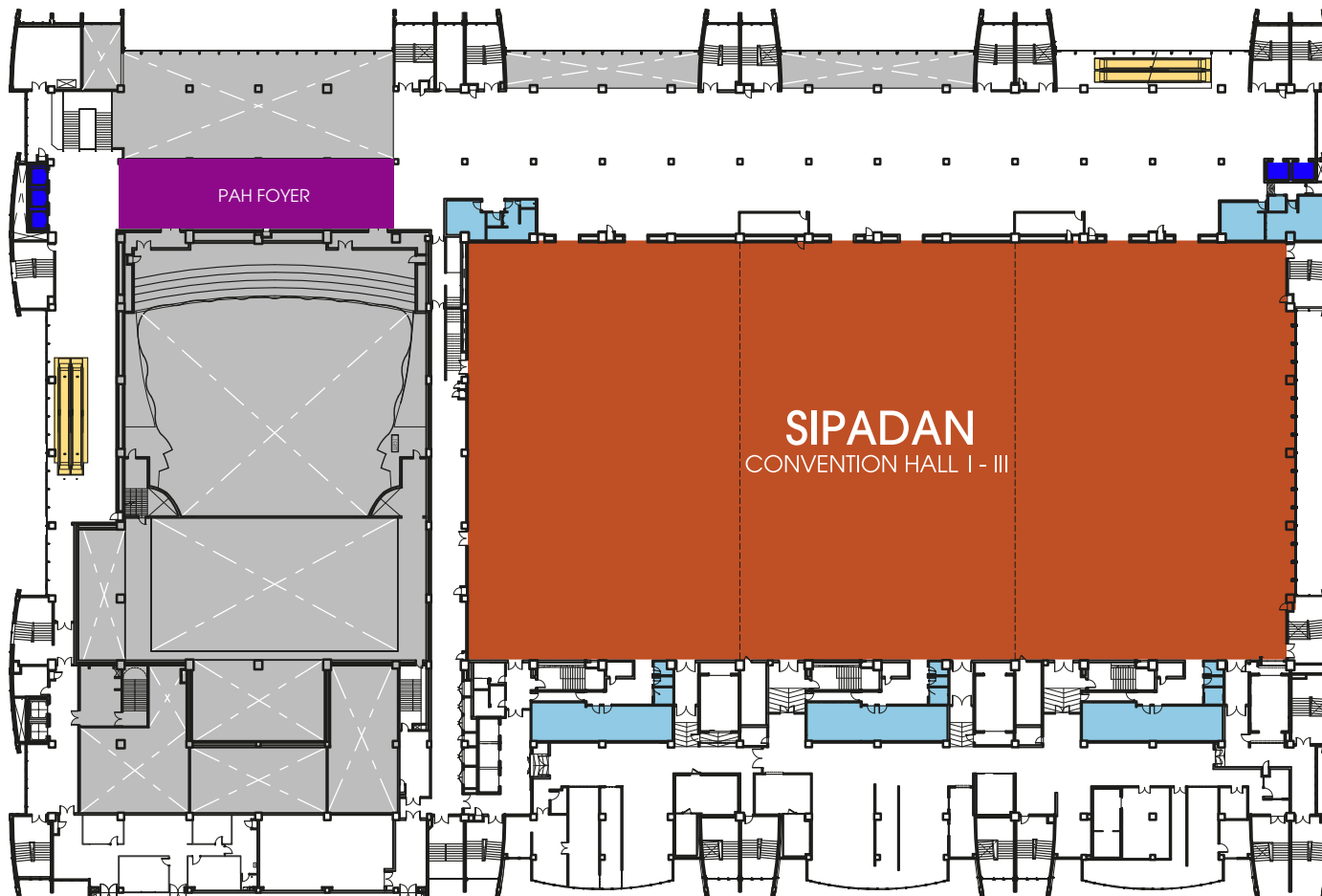

Room	Length	Width	Gross area	
	m	m	sqm	sqf
PAH FOYER	48.650	8.160	396.98	4,273.06

Notes

- WASHROOM
- ESCALATOR
- ELEVATOR
- PAH FOYER
- CONVENTION HALL

LEVEL 4 - SIPADAN CONVENTION HALL

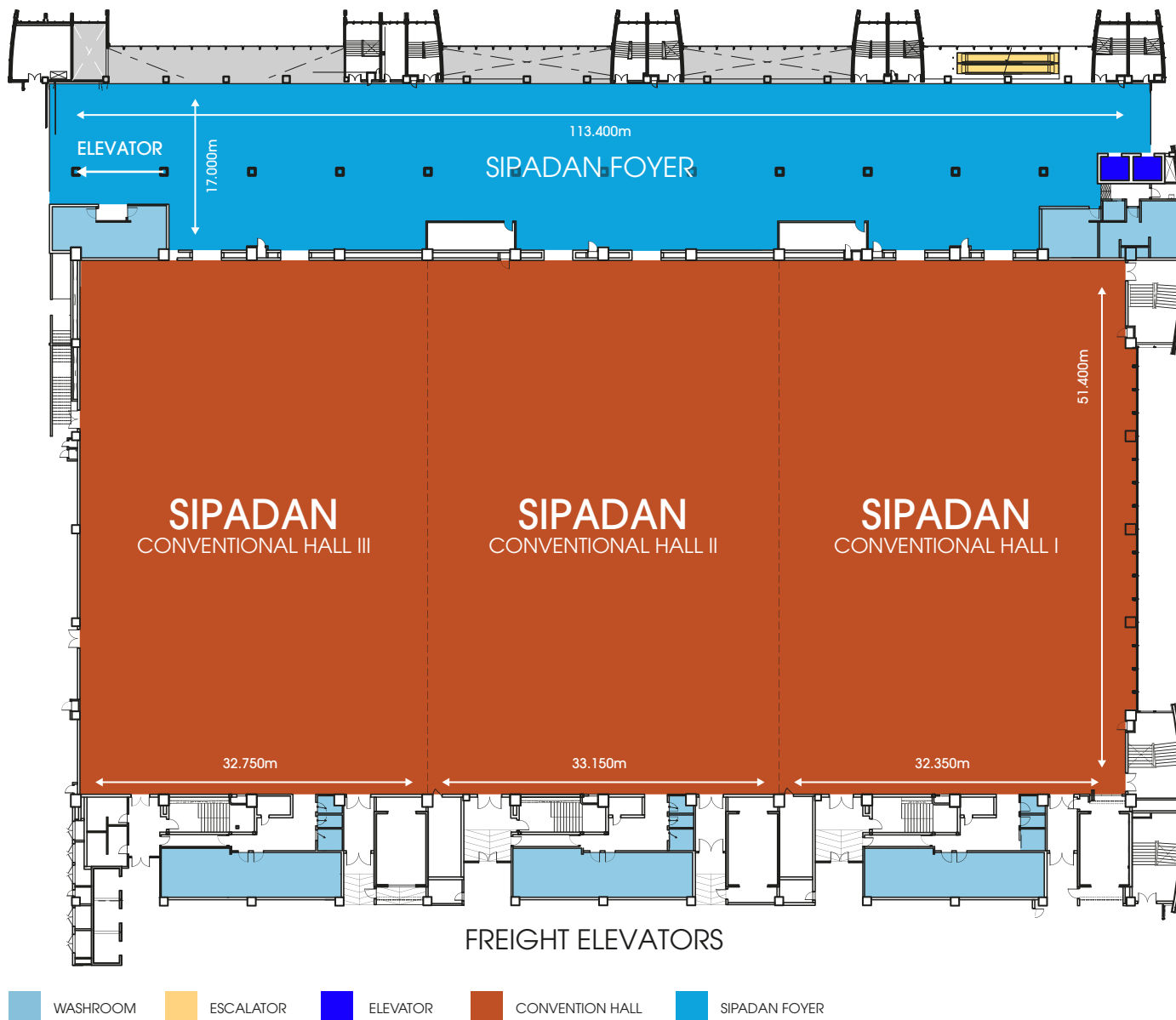

Room	Length	Width	Gross area	
	m	m	sqm	sqf
Sipadan Foyer	17.000	113.400	1,927.80	20,750.67
Sipadan I	51.400	32.350	1,662.79	17,898.12
Sipadan II	51.400	33.150	1,703.91	18,340.73
Sipadan III	51.400	32.750	1,683.35	18,119.43
Sipadan I-III	51.400	98.250	5,050.05	54,358.29

Notes

LEVEL 5 - FLEXIBLE FUNCTION ROOMS

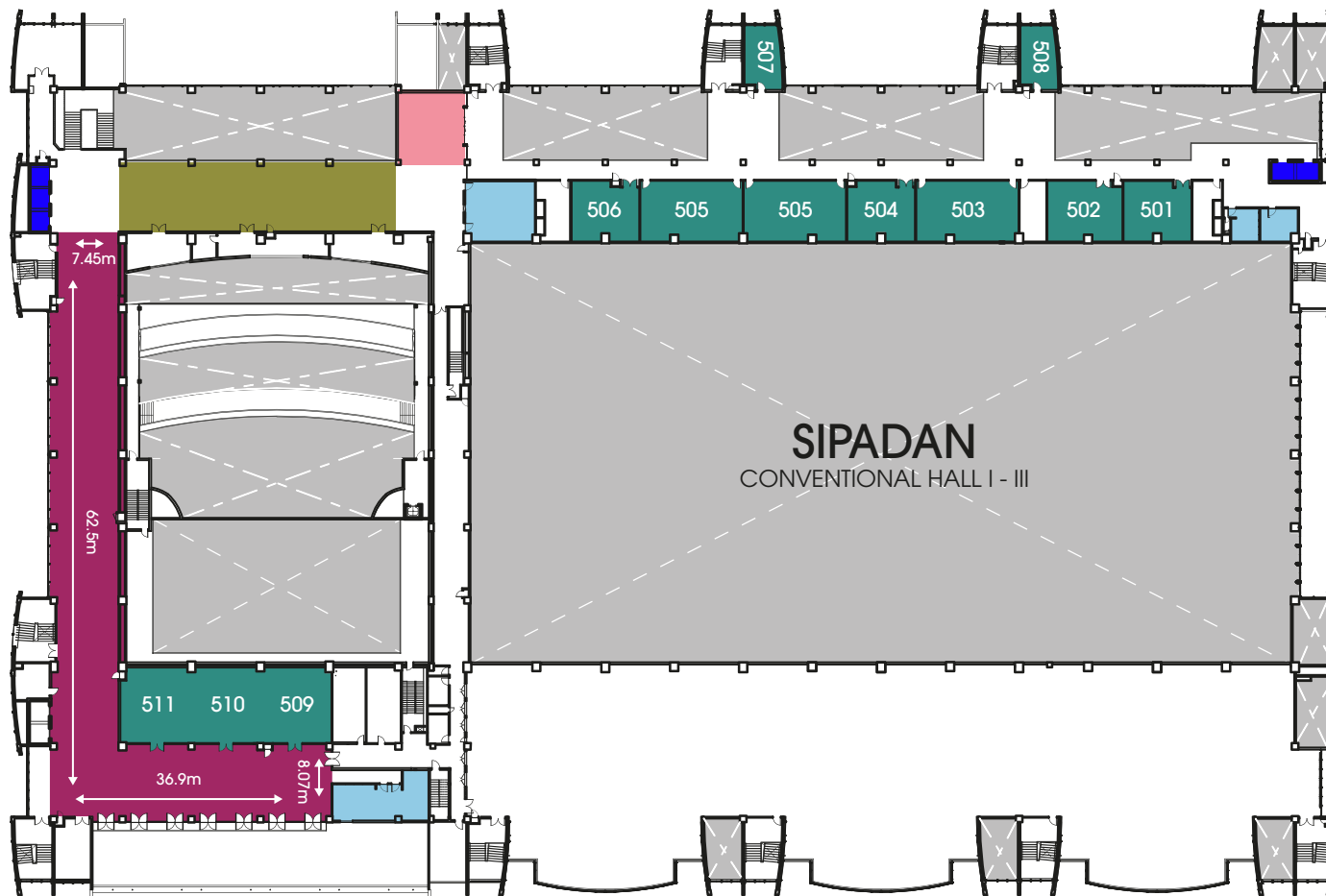

Room	Length	Width	Gross area	
	m	m	sqm	sqf
501 Kadamaian	8.375	7.480	62.51	672.85
502 Mesilau	9.236	7.481	69.09	743.68
503 Dinawan	12.540	7.491	93.94	1,011.16
504 Madai	8.525	6.692	57.05	614.08
505 Sepilok	25.160	7.500	188.70	2,031.15
506 Selingan	8.347	6.579	54.91	591.05
507 Klias	7.316	4.660	34.09	366.94
508 Monsopiad	7.195	4.695	33.78	363.60

Notes

- WASHROOM
- ELEVATOR
- MEETING ROOM
- KINABALU FOYER I-II
- LOTUS
- LAYANG-LAYANG LANE

LEVEL 5 - EXCLUSIVE SECTION

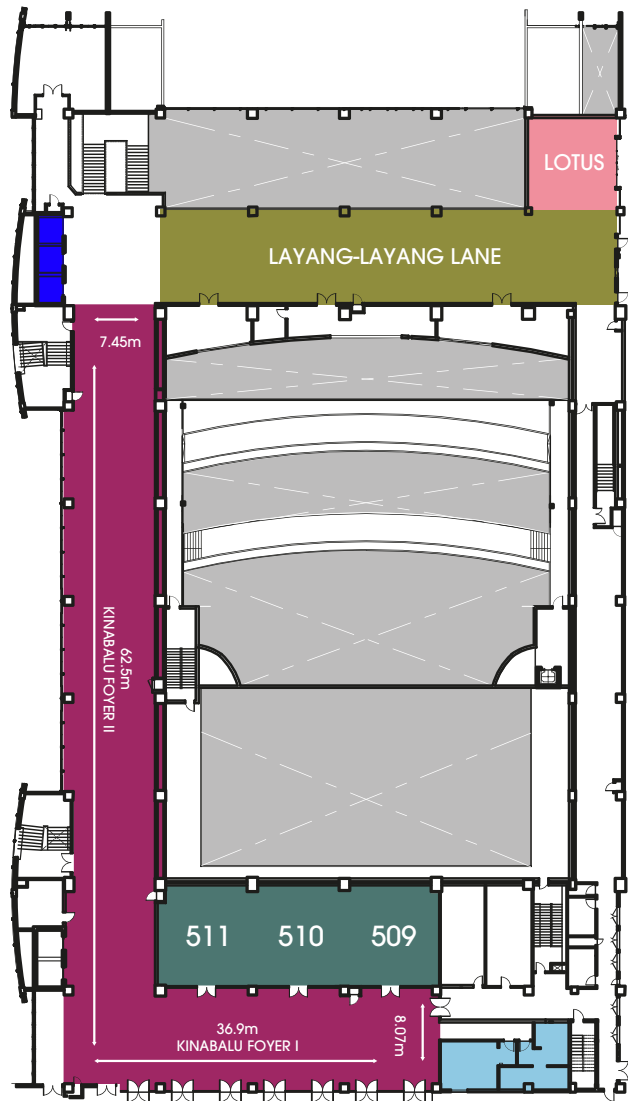



Room	Length	Width	Gross area	
	m	m	sqm	sqf
509 Kinabalu I	8.518	8.750	74.53	802.23
510 Kinabalu II	8.518	8.540	72.74	782.97
511 Kinabalu III	8.518	8.750	74.53	802.23
Kinabalu Foyer I	36.900	8.070	297.78	205.28
Kinabalu Foyer II	62.500	7.454	465.87	5,014.64
Layang-Layang Lane	50.700	8.255	418.53	4,505.02
Lotus	17.750	7.760	137.74	1,482.62

Notes

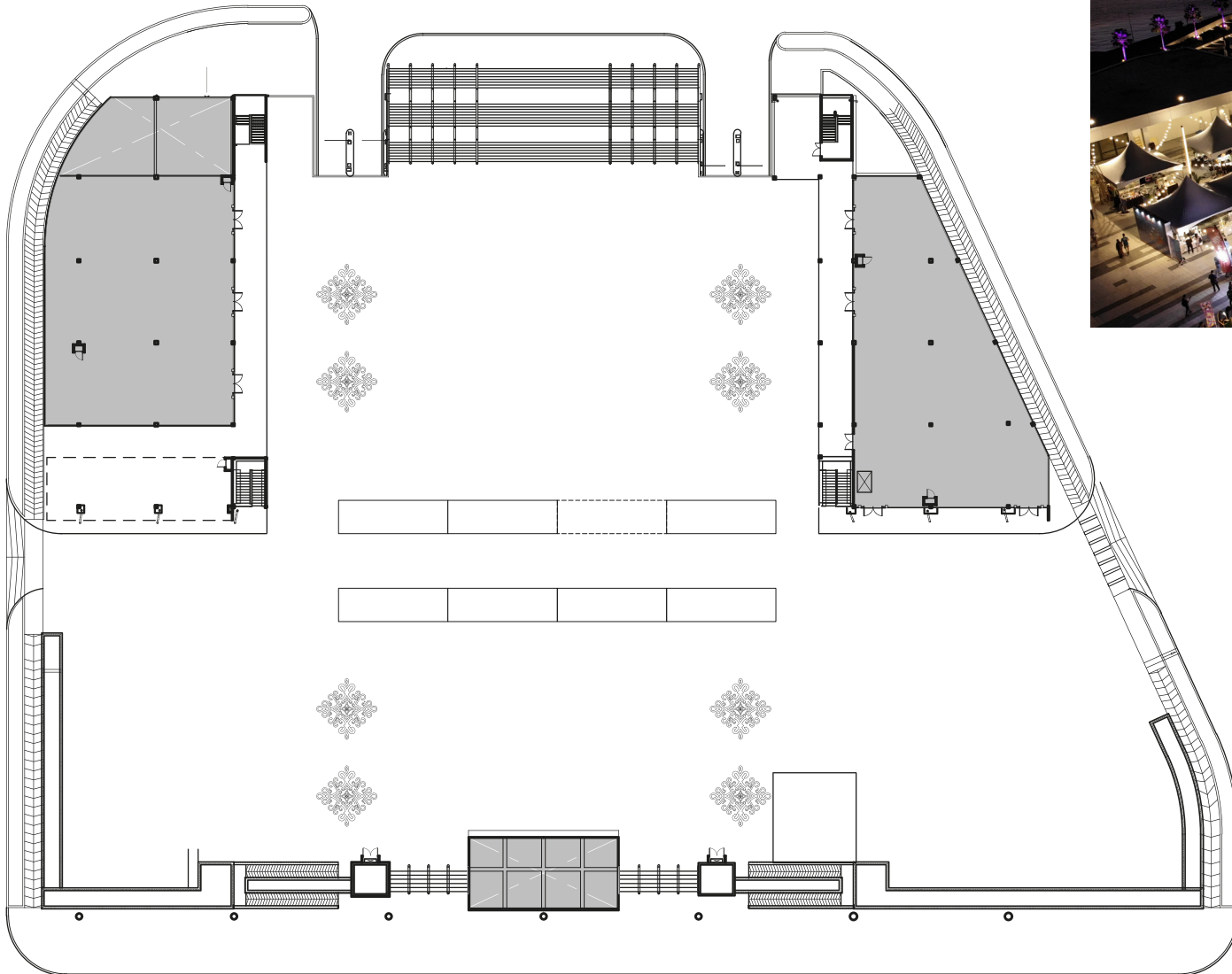
LEVEL 3 - JESSELTON SQUARE

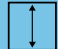

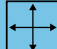
Room				
	m	m	sqm	sqf
Jesselton Square	-	-	6,954.00	74,852.23

Notes



meranti cafe

LOBBY, LEVEL 3

Operation Hour

Sunday - Wednesday | 8.00am to 6.00pm

Thursday - Saturday | 8.00am to 10.00pm

MERANTI CAFÉ is inspired by the 100.8metre endangered yellow Meranti tree (*Shorea Faquetiana*), the world's tallest known living tropical tree found in Danum Valley Conservation Area.

Sabah International Convention Centre stands tall and proud leading the environmental sustainability principles, by raising awareness and instigating changes not only within the local community but on a global platform as well.

Located in the "rainforest wing" (Level 3) of the convention centre, **MERANTI CAFE** is a perfect homage to commemorate the conservation efforts of Sabah International Convention Centre.



Scan here to read more.

"The world's tallest known tropical tree has been found - and climbed" www.nationalgeographic.com



**SABAH INTERNATIONAL
CONVENTION CENTRE**

SABAH INTERNATIONAL CONVENTION CENTRE

Tanjung Lipat, Jalan Tun Fuad Stephens
88400 Kota Kinabalu, Sabah, Malaysia

www.siccsabah.com



(Tel) +6088 206 000

(Email) sales@siccsabah.com

[f](#) [@](#) [d](#) [X](#) [in](#) @siccsabah